

Anasept® the clear, safe and most effective choice for the antiseptic preparation of the skin site for:

- Graft-Fistula Cannulation
- Exit Site Dressing Change for Peritoneal Dialysis
- Central Line Site Preparation

Anasept® Antimicrobial Skin & Wound Cleanser is available in easy to use spray bottles and economical pour bottles:

Ordering Information

Anasept® Antimicrobial Skin and Wound Cleanser



Catalog No.	Size
4004C (Dispensing Cap)	4 oz.
4008C (Dispensing Cap)	8 oz.
4004SC (Sprayer)	4 oz.
4008SC (Sprayer)	8 oz.
4016C (Dispensing Cap)	15 oz.

Health Canada License #97043



Anasept® Antimicrobial Skin & Wound Gel is available as a long-acting, clear, topical hydrogel in convenient 3 oz. and 1.5 oz. tubes.

Catalog No.	Size
5003G	3 oz. tube
5015G	1.5 oz. tube

Health Canada License #97167



ANACAPA
TECHNOLOGIES

Anacapa Technologies, Inc.
301 East Arrow Highway, Suite 106
San Dimas, CA 91773

Toll-Free: 800-489-2591
Direct: 909-394-7795
Fax: 909-394-9895

e-mail: anacapa@anacapa-tech.net
www.anacapa-tech.net

Daily Peritoneal Dialysis Catheter Care Protocol

By Alan Falcioni, RN, BSN, CNN



The goal of daily exit site care is to prevent infection by maintaining a clean and dry environment around the exit site area. This procedure also gives one the opportunity to inspect the exit site for signs of irritation or infection. Liquid soap is preferred, and some dialysis centers may recommend the anti-bacterial type. The catheter **MUST** remain anchored or secured to the abdomen at all times in order to prevent trauma to the site.

SUPPLIES NEEDED:

- ▶ Tape
- ▶ Liquid pump soap
- ▶ Cotton applicator
- ▶ Anasept® Antimicrobial Skin and Wound Gel
- ▶ Dressing



PROCEDURE:

1. Remove old dressing from catheter exit site.



2. Tape catheter to abdomen - do **NOT** allow catheter to dangle.



3. Shower. Gently wash catheter exit site and catheter with liquid soap and a clean, soft washcloth or your fingers. Do **NOT** remove any scabs or crusting.

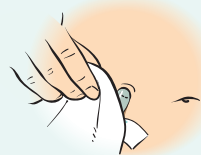

4. Rinse thoroughly.

5. Pat exit site and catheter dry with a clean towel.

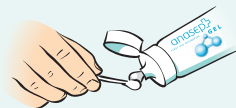

6. Place a small amount (pea-size) of Anasept® Gel on cotton applicator.

7. Gently swab Anasept® Gel around catheter exit site including the area underneath the catheter.

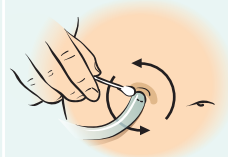

8. Apply dressing to the exit site.



9. Re-tape the catheter securely to the abdomen.

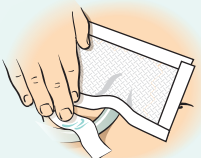

Reference:
Peritoneal Dialysis-Related Infections Recommendations: 2005 Update.
Peritoneal Dialysis International, Volume 25, Number 2, 2005.

Anasept® is a registered trademark of Anacapa Technologies, Inc.
San Dimas, CA 91773
© Anacapa Technologies, Inc. 2017